

Facing a Quilt

Good alternative to binding for art or modern quilts where you want the image to end or flow off at the edges.

Batiks are a good choice for the facing fabric.

This method is compliments of Kathy Loomis, see her blog for another option for facing quilts...

<http://artwithaneedle.blogspot.com/2011/03/perfect-faced-quilts-tutorial.html>

Trim your quilt as you would typically prepare it for traditional binding... 90 degree corners, back and batting trimmed to size of quilt front, etc.

Cut 4 corner pieces of your facing fabric like the template pictured here. This corner piece is not a 90 degree angle! Press both ends out or over (not under) $1/4$ ".

Place one of these pieces in each of the four corners on the front of your quilt, right sides together. Gently stretch or pull the sides to fit the 90 degree corner of your quilt and pin in place.

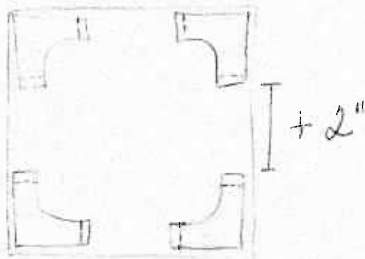

Measure the distance between the ends of two of these corners and cut a strips $1\ 1/2$ " x width of opening plus 2". You can make this width of your strip narrower than $1\ 1/2$ " if you'd like. Repeat for all four sides. Probably you will need 4 strips the same size (if your quilt is square) or 2 of one length and 2 of another length (if your quilt is rectangular).

Place the end of a strip ^{on top of} ~~under~~ the corner piece, so that the corner piece overlaps the strip by about 1" and make sure the strip length lines up with the edge of the quilt. Place the other end of the strip ^{on top of} ~~under~~ the next corner piece so that the corner piece overlaps it by about 1". Pin in place. Continue around the quilt, all four corners and four sides.

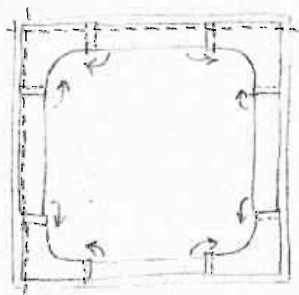

Sew from one corner all along the side and sew off the quilt/cross over the corner, do not *turn* the corner to continue sewing. It's a good idea to reduce your stitch length for the last $1/2$ " of this line of sewing.

At each corner, clip on the diagonal and turn facing to the back. Carefully poke corner out and use heavy steam to get the facing and corner as flat as possible. Turn the facing in $1/4$ " and stitch down by hand.